

REV.	DESCRIPTION	ECN NO.	NAME	DATE
0	FIRST EDITION	N/A	Liu	2020-12-23
1	UPDATE THE VIEW	N/A	Liu	2021-04-06

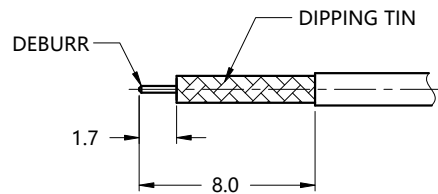

ALL PARTS MUST MEET TO RoHS REQUIREMENTS

NOTES:
 1.CONTACT PIN TO CAPTIVE
 2.FERRULE TO SOLDER
 3.ADDS SIZE : 12.56 mm



RECOMMENDED CABLE STRIPPING DIM'S

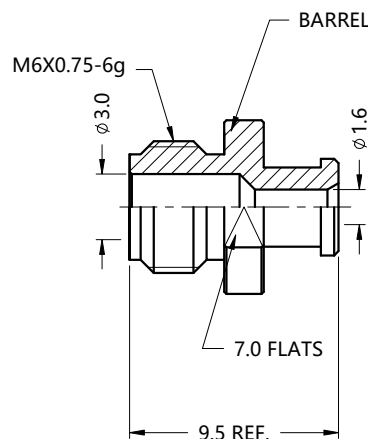
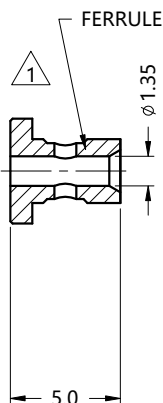
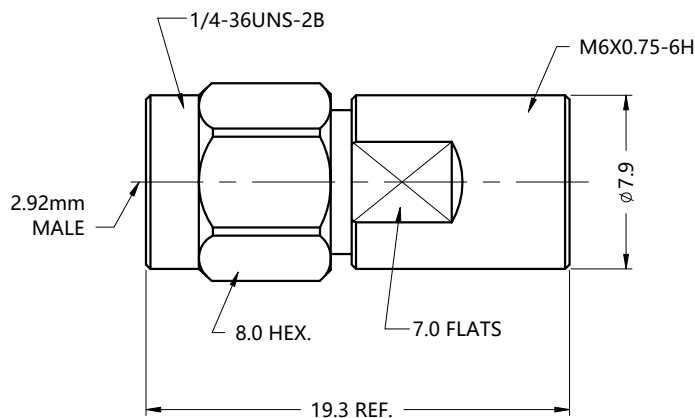

MATERIALS AND PLATING		UNIT: MICRO-INCHES
PART NAME	MATERIALS	PLATING
BODY/SHELL	STAINLESS STEEL	PASSIVATION
INSULATOR	PEI	N/A
CONTACT PIN	BeCu C17300	GOLD 50 u"/COPPER
FERRULE	BRASS C3604	GOLD 10 u" / NICKEL/COPPER
BARREL	STAINLESS STEEL	PASSIVATION
GASKET	SILICONE	RED

ELECTRICAL CHARACTERISTICS	
IMPEDANCE	50 Ω
VOLTAGE RATING	175 V(rms)
FREQUENCY RANGE	0 ~ 40 GHz
DIELECTRIC WITHSTANDING VOLTAGE	> 500 V
CONTACT RESISTANCE	CENTER CONTACT < 0.75 mΩ
	OUTER CONTACT < 0.13 mΩ
INSULATION RESISTANCE	> 500 MΩ
INSERTION LOSS	< 0.1X√f GHz dB
VSWR	< 1.30
3RD INTERMODULATION	N/A

MECHANICAL CHARACTERISTICS	
FORCE TO ENGAGE AND DISENGAGE	N/A
CENTER CONTACT RETENTION FORCE	> 6 lbs
RECOMMENDED COUPLING TORQUE	7-10 in-lbs
COUPLING NUT RETENTION FORCE	> 100 lbs
DURABILITY	> 500 cycles

ENVIRONMENTAL PARAMETER	
TEMPERATURE RANGE	-40 °C ~ +125 °C

* CUSTOMER OUTLINE DRAWING

UNLESS OTHERWISE SPECIFIED:
 1) EDGES : C0.15 MAX ;
 2) REMOVE ALL BURRS ;
 3) SURFACE ROUGHNESS : Ra1.6 ;
 4) UNITS : mm ;
 5) DIMENSIONS TOLERANCES
 DECIMALS : .x ±0.3 .xx ±0.2 .xxx±0.1;
 ANGLES : ± 5°.

THIRD ANGLE PROJECTION

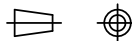

APPROVED :

CUSTOMER P/N :

CHECKED :

SCALE :

3: 1

DRAWING :

DATE : 2021-04-06

PAGE : 1/1



TITLE : 2.92mm MALE S/T CLAMP FOR PT-FLEX 047 CABLE,50Ω

DRAWING NO. :

5P9M15S-A420-001

COMPANY WEBSITE : www.slkcorp.com

CUSTOMER OUTLINE DRAWING